

APOLLO LED AL6666

IP65



In Association with:
 KINGSUN

Benefits

- Easy assembly and maintenance
- Modular future-proof design
- Excellent thermal management
- High reliability and performance from Cree or Lumiled LEDs
- LM-80 compliant
- 100,000 life time to 70% lumen maintenance
- Independent LED drive compartment with Philips Xitanium LED electronic driver(s) built in
- Adaptive for most bracket diameters
- Internal adjustable luminaire elevation

Technical Features

- 4 Optics available for tailored performance A3 Type 3 Long as standard)

- Modular Designed LEDs for easy maintenance
- Philips drivers (Xitanium), dimming available as an option 1:10 Dali
- Utilising CREE LEDs as standard or Lumiled LEDs as an option
- Adjustable mounting bracket to allow for luminaire elevation both bracket or post mounting solutions
- Post top and side mounted spigot entry positions 60mm & 40mm with adaptor accessory (State at time of quoting & ordering)

- Independent LED driver compartment
- NEMA Photoelectric interface option available
- CE and UL Certified
- 5 year Warranty for luminaire body, LED modules and driver

Applications

- Road • Open Area • Rail • Amenity

Colour

-  Light Grey

	Wattage	LED Modules	No. of LEDs	Power Consumption	Typical Flux 5000K	Dimensions (L x W x D mm)	Weight (kg)	Wind Area (m ²)
AL6666 / 30	30W	1	14	33W	2783	502 x 346 x 102	3.4kg	0.07
AL6666 / 35	35W	1	14	38W	3150	502 x 346 x 102	3.4kg	0.07
AL6666 / 60	60W	2	28	62W	5566	564 x 346 x 102	4.3kg	0.07
AL6666 / 70	70W	2	28	73W	5850	564 x 346 x 102	4.3kg	0.07
AL6666 / 90	90W	3	42	93W	8349	626 x 346 x 102	5.3kg	0.07
AL6666 / 120	120W	4	56	123W	11132	688 x 346 x 102	6.3kg	0.08
AL6666 / 150	150W	5	70	155W	13915	750 x 346 x 102	7.3kg	0.08
AL6666 / 180	180W	6	84	185W	16696	812 x 346 x 102	8.3kg	0.08
AL6666 / 210	210W	7	98	216W	19473	874 x 346 x 102	9.3kg	0.09
AL6666 / 240	240W	8	112	246W	22257	936 x 346 x 102	10.3kg	0.10
AL6666 / 270	270W	9	126	277W	25040	998 x 346 x 102	11.3kg	0.10
AL6666 / 300	300W	10	140	308W	27823	1060 x 346 x 102	12.3kg	0.11

Dimensions

Dimensions in mm

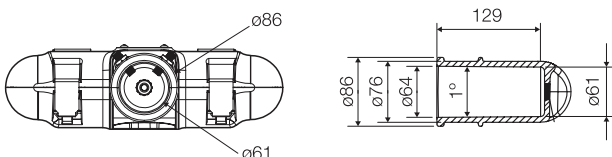

Key features

Colour Rendering:	>75
Power Factor:	>0.95
Luminaire Efficiency:	>85%
Ambient Environment:	Temperature: -40 ~ +50°C ; Humidity: 10% ~ 95%
Lifespan:	>50000 hours
Driver Current:	700mA