

# FLOODLIGHTING BRACKETS

## SINGLE, DOUBLE, TRIPLE

Hot dip galvanised to BS EN1461:1999

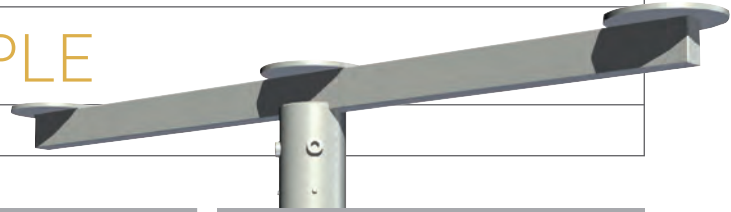

### Single

Grub screws, fixing bolts & cable glands included

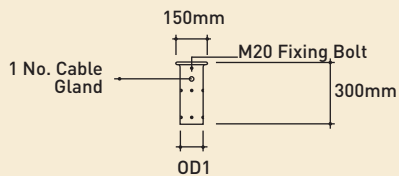

### Double

Grub screws, fixing bolts & cable glands included

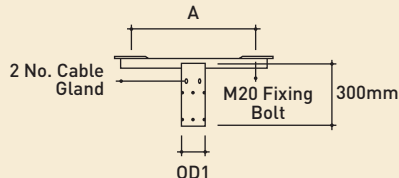

### Triple

Grub screws, fixing bolts & cable glands included

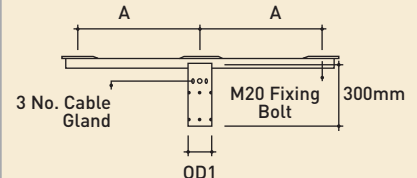

## Technical Data

Dimensions (mm)					
Ref	Type	To Fit Shaft or Spigot Ø	OD1	A	Approx Weight (kg)
FL1/1	Single	76	89	-	3.0
FL1/2	Double	76	89	600	6.0
FL1/3	Double	76	89	800	7.0
FL1/4	Triple	76	89	600	10.0
FL1/5	Triple	76	89	800	11.5
FL2/1	Single	89	101	-	4.0
FL2/2	Double	89	101	600	7.5
FL2/3	Double	89	101	800	8.0
FL2/4	Triple	89	101	600	10.5
FL2/5	Triple	89	101	800	12.0
FL5/1	Single	102	114	-	3.0
FL5/2	Double	102	114	600	6.75
FL5/3	Double	102	114	800	7.5
FL5/4	Triple	102	114	600	10.0
FL5/5	Triple	102	114	800	12.0
FL4/1	Single	114	127	-	5.5
FL4/2	Double	114	127	600	9.0
FL4/3	Double	114	127	800	10.5
FL4/4	Triple	114	127	600	12.0
FL4/5	Triple	114	127	800	13.5
FL3/1	Single	127	140	-	5.5
FL3/2	Double	127	140	600	9.0
FL3/3	Double	127	140	800	10.0
FL3/4	Triple	127	140	600	12.0
FL3/5	Triple	127	140	800	14.0
FL7/1	Single	152	168	-	6.0
FL7/2	Double	152	168	600	9.5
FL7/3	Double	152	168	800	11.0
FL7/4	Triple	152	168	800	12.5
FL7/5	Triple	152	168	800	14.0

# OUTREACH BRACKETS

## SINGLE & DOUBLE PROJECTION

Hot dip galvanised to BS EN1461:1999



### Single Projection

Grub screws included

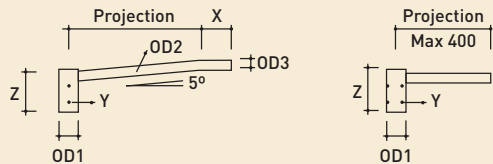

### Double Projection

Grub screws included

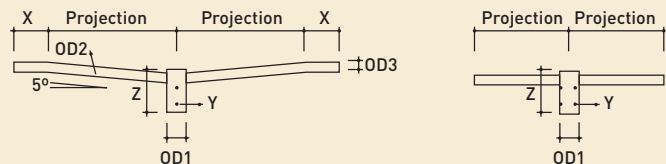

OD2: standard  $\varnothing$  42mm. For 48mm insert /48.  
For 60mm insert /60, following product codes below.

Y = 2 rows of 3 No. M10 grub screws (89 & below),  
2 rows of 4 No. M10 grub screws (114 & below).

NOTE: Perpendicular arm on  
brackets up to 400mm

### Technical Data

Dimensions (mm)

Ref	To Fit					Single Projection Approx Weight (kg)	Double Projection Approx Weight (kg)
	Projection	Shaft or Spigot $\varnothing$	OD1	OD2	Z		
PR1-03/S & D	300	60	-	42	195	2.0	3.0
PR1-05/S & D	500	60	76	42	350	2.5	4.5
PR1-10/S & D	1000	60	76	42	350	4.5	7.0
PR1-15/S & D	1500	60	76	42	350	6.0	10.0
PR2-03/S & D	300	76	-	42	195	2.2	3.1
PR2-05/S & D	500	76	89	42	350	3.0	4.5
PR2-10/S & D	1000	76	89	42	350	4.5	7.0
PR2-15/S & D	1500	76	89	42	350	6.0	10.0
PR4-03/S & D	300	89	-	42	-	4.0	4.9
PR4-05/S & D	500	89	101	42	350	4.0	5.5
PR4-10/S & D	1000	86	101	42	350	5.5	8.0
PR4-15/S & D	1500	89	101	42	350	7.0	11.0
PR4-20/S & D	2000	89	101	48	350	10.0	17.0
PR5-05/S & D	500	127	140	42	350	5.6	6.9
PR5-10/S & D	1000	127	140	42	350	6.9	9.5
PR5-15/S & D	1500	127	140	42	350	8.5	12.4
PR6-03/S & D	300	114	-	42	-	5.1	5.9
PR6-05/S & D	500	114	127	42	350	5.5	7.0
PR6-10/S & D	1000	114	127	42	350	7.0	9.5
PR6-15/S & D	1500	114	127	42	350	8.5	12.5
PR6-20/S & D	2000	114	127	48	350	11.5	18.5
PR6-25/S & D	2500	114	127	60	350	16.0	27.5
PR6-30/S & D	3000	114	127	60	350	18.0	31.5
PR7-03/S & D	300	102	114	42	350	4.8	5.8
PR7-05/S & D	500	102	114	42	350	5.2	6.1
PR7-10/S & D	1000	102	114	42	350	7.3	8.4
PR7-15/S & D	1500	102	114	42	350	10.4	11.6
PR8-05/S & D	500	152	168	42	350	5.0	6.5
PR8-10/S & D	1000	152	168	42	350	9.1	6.4
PR8-15/S & D	1500	152	168	42	350	7.8	11.9

# UPLIFT BRACKETS

## SINGLE & DOUBLE PROJECTION

Hot dip galvanised to BS EN1461:1999

### Single Projection

Grub screws included

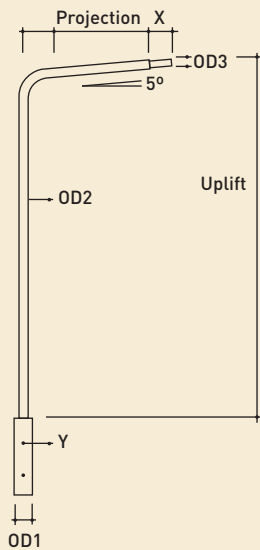

### Double Projection

Grub screws included

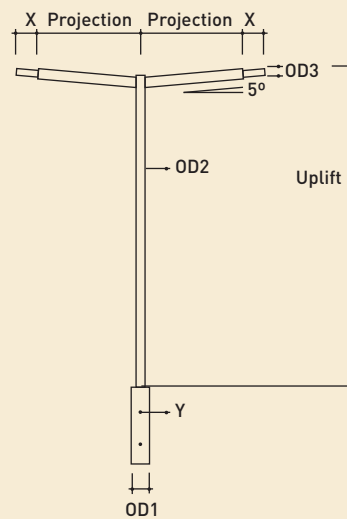

X = 100mm standard.

Y = 2 rows of 4 No. M10 grub screws. Fits to standard 76mm spigot (product code/SP), length = 230mm.

### Technical Data

Dimensions (mm)								
Ref	To Fit Projection	To Fit Uplift	To Fit Shaft or Spigot Ø	OD1	OD2	OD3	Single Projection Approx Weight (kg)	Double Projection Approx Weight (kg)
PU1-0510/S & D	500	1000	76	89	48	42	8.5	10.5
PU1-1010/S & D	1000	1000	76	89	48	42	11.0	15.5
PU1-1020/S & D	1000	2000	76	89	48	42	15.0	19.5
PU1-1520/S & D	1500	2000	76	89	48	42	17.5	23.5
PU1-2020/S & D	2000	2000	76	89	48	42	20.0	29.0